

SLFL Pressed Steel Flange Units

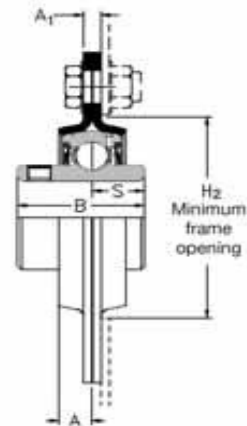

Shaft Diameter (mm)		RHP designation	Variations	Basic Insert	Casting group	Dimensions(mm)										
Metric Range	Imperial Range		A	EC	DEC	L	H	H2	J	N	A	A1	B	S		
12		SLFL12	•			1017	1	58.7	81	49	63.5	7.1	6.7	4	27.38	11.55
	12.7	SLFL1/2	•			1017	1	58.7	81	49	63.5	7.1	6.7	4	27.38	11.55
15		SLFL15	•			1017	1	58.7	81	49	63.5	7.1	6.7	4	27.38	11.55
	15.875	SLFL5/8	•			1017	1	58.7	81	49	63.5	7.1	6.7	4	27.38	11.55
16		SLFL16	•			1017	1	58.7	81	49	63.5	7.1	6.7	4	27.38	11.55
17		SLFL17	•			1017	1	58.7	81	49	63.5	7.1	6.7	4	27.38	11.55
	19.05	SLFL3/4	•	•	•	1020	2	66.7	90.5	55	71.5	8.7	7.7	4	30.96	12.75
20		SLFL20	•	•	•	1020	2	66.7	90.5	55	71.5	8.7	7.7	4	30.96	12.75
	22.225	SLFL7/8		•	•	1025	3	71	95.3	60	76	8.7	8.7	4	34.11	14.32
	23.812	SLFL15/16		•	•	1025	3	71	95.3	60	76	8.7	8.7	4	34.11	14.32
25		SLFL25	•	•	•	1025	3	71	95.3	60	76	8.7	8.7	4	34.11	14.32
	25.4	SLFL1	•	•	•	1025	3	71	95.3	60	76	8.7	8.7	4	34.11	14.32
	28.575	SLFL1-1/8		•	•	1030	4	84.1	112.7	71	90.5	10.5	9	5	38.1	15.93
30		SLFL30	•	•	•	1030	4	84.1	112.7	71	90.5	10.5	9	5	38.1	15.93
	30.16	SLFL1-3/16		•	•	1030	4	84.1	112.7	71	90.5	10.5	9	5	38.1	15.93
	31.75	SLFL1-1/4	•	•	•	1030	4	84.1	112.7	71	90.5	10.5	9	5	38.1	15.93

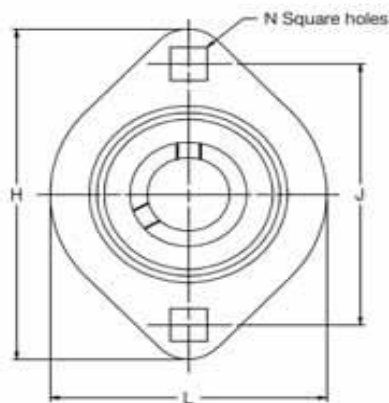

Note: these units are not re-greaseable