

Four Bolt Flanged Unit

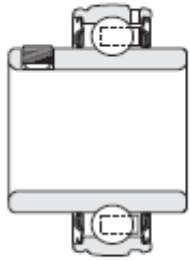

1000G

Standard

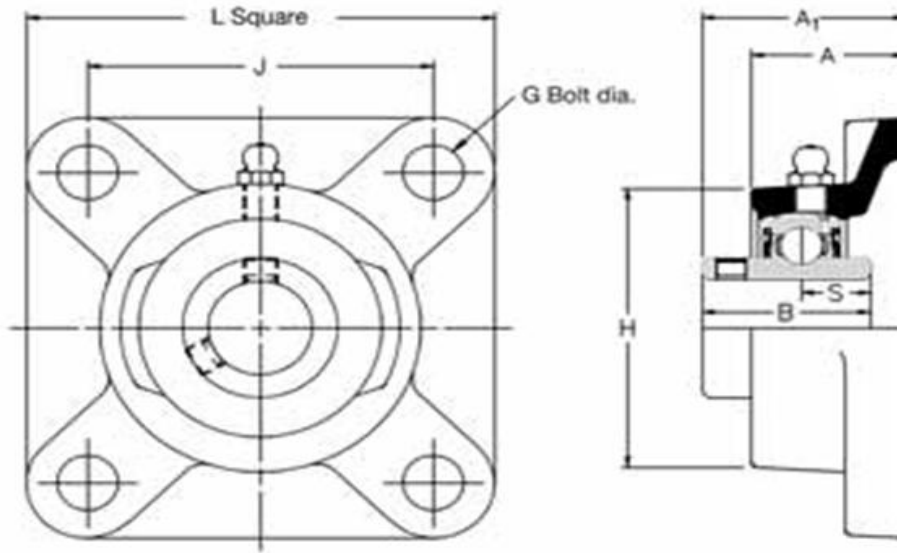
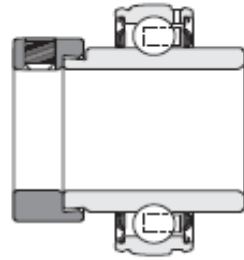

1000DECG

DEC Type



1200G

A Type

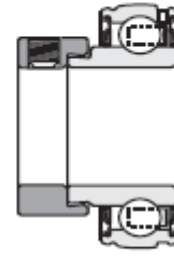

1200ECG

EC Type

See [Housed Bearing Insert](#) pages for dimensional detail

Four Bolt Flange Units

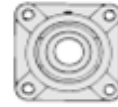

Shaft Diameter (mm)		RHP designation	Variations			Basic Insert	Casting group	Dimensions(mm)							
Metric Range	Imperial Range		A	EC	DEC		Casting Square L	Flange Diameter H	Flange Height A	Width Max A1	Inner Race Width B	Inner Race Centre s	Bolt Hole G	Bolt Centres J	
12		SF12		•		1017	1	76.20	52.50	24.60	32.87	27.38	11.58	10	54.0
	12.7	SF1/2		•		1017	1	76.20	52.50	24.60	32.87	27.38	11.58	10	54.0
15		SF15		•		1017	1	76.20	52.50	24.60	32.87	27.38	11.58	10	54.0
	15.875	SF5/8		•		1017	1	76.20	52.50	24.60	32.87	27.38	11.58	10	54.0
16		SF16		•		1017	1	76.20	52.50	24.60	32.87	27.38	11.58	10	54.0
17		SF17		•		1017	1	76.20	52.50	24.60	32.87	27.38	11.58	10	54.0
	19.05	SF3/4	•	•	•	1020	2	85.70	60.30	27.80	37.26	31.00	12.73	10	63.5
20		SF20	•	•	•	1020	2	85.70	60.30	27.80	37.26	31.00	12.73	10	63.5
	22.225	SF7/8		•	•	1025	3	95.30	68.00	28.60	38.84	34.10	14.33	10	70.0
	23.812	SF15/16		•	•	1025	3	95.30	68.00	28.60	38.84	34.10	14.33	10	70.0
25		SF25	•	•	•	1025	3	95.30	68.00	28.60	38.84	34.10	14.33	10	70.0
25		MSF25				1030	1	108.00	82.60	29.80	42.21	38.10	15.93	10	82.5
	25.4	SF1	•	•	•	1025	3	95.30	68.00	28.60	38.84	34.10	14.33	10	70.0
	25.4	MSF1				1030	1	108.00	82.60	29.80	42.21	38.10	15.93	10	82.5
	28.575	SF1-1/8		•	•	1030	4	108.00	82.60	29.80	42.21	38.10	15.93	10	82.5
30		SF30	•	•	•	1030	4	108.00	82.60	29.80	42.21	38.10	15.93	10	82.5
30		MSF30				1035	2	117.50	95.30	31.40	46.41	42.90	17.53	12	92.0
	30.16	SF1-3/16		•	•	1030	4	108.00	82.60	29.80	42.21	38.10	15.93	10	82.5
	30.16	MSF13/16				1035	2	117.50	95.30	31.40	46.41	42.90	17.53	12	92.0
	31.75	SF1-1/4R	•	•	•	1030	4	108.00	82.60	29.80	42.21	38.10	15.93	10	82.5
	31.75	SF1-1/4	•	•	•	1035	5	117.50	95.30	31.40	46.41	42.90	17.53	12	92.0
	31.75	MSF1-1/4				1035	2	117.50	95.30	31.40	46.41	42.90	17.53	12	92.0
	34.925	SF1-3/8		•	•	1035	5	117.50	95.30	31.40	46.41	42.90	17.53	12	92.0
	34.925	MSF1-3/8				1040	3	130.20	101.60	34.90	54.18	49.20	19.03	12	101.5
35		SF35	•	•	•	1035	5	117.50	95.30	31.40	46.41	42.90	17.53	12	92.0
35		MSF35				1040	3	130.20	101.60	34.90	54.18	49.20	19.03	12	101.5
	36.512	SF1-7/16		•	•	1035	5	117.50	95.30	31.40	46.41	42.90	17.53	12	92.0
	36.512	MSF1-7/16				1040	3	130.20	101.60	34.90	54.18	49.20	19.03	12	101.5
	38.1	SF1-1/2	•	•	•	1040	6	130.20	101.60	34.90	54.18	49.20	19.03	12	101.5
	38.1	MSF1-1/2				1045	4	136.50	111.10	35.30	54.18	49.20	19.03	16	105.0
40		SF40	•	•	•	1040	6	130.20	101.60	34.90	54.18	49.20	19.03	12	101.5
40		MSF40				1045	4	136.50	111.10	35.30	54.18	49.20	19.03	16	105.0
	41.275	SF1-5/8		•	•	1045	7	136.50	111.10	35.30	54.18	49.20	19.03	16	105.0

Four Bolt Flange Units

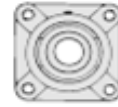

Shaft Diameter (mm)		RHP designation	Variations			Basic Insert	Casting group	Dimensions(mm)							
Metric Range	Imperial Range		A	EC	DEC			Casting Square L	Flange Diameter H	Flange Height A	Width Max A1	Inner Race Width B	Inner Race Centre s	Bolt Hole G	Bolt Centres J
42.862		SF1-11/16		•	•	1045	7	136.50	111.10	35.30	54.18	49.20	19.03	16	105.0
42.862		MSF1-11/16				1050	5	142.90	115.90	39.70	60.53	51.60	19.04	16	111.0
44.45		SF1-3/4	•	•	•	1045	7	136.50	111.10	35.30	54.18	49.20	19.03	16	105.0
44.45		MSF1-3/4				1050	5	142.90	115.90	39.70	60.53	51.60	19.04	16	111.0
45		SF45	•	•	•	1045	7	136.50	111.10	35.30	54.18	49.20	19.03	16	105.0
45		MSF45				1050	5	142.90	115.90	39.70	60.53	51.60	19.04	16	111.0
47.625		SF1-7/8		•	•	1050	8	142.90	115.90	39.70	60.53	51.60	19.04	16	111.0
47.625		MSF1-7/8				1055	6	161.90	127.00	43.70	64.31	55.60	22.24	16	130.0
49.212		SF1-15/16		•	•	1050	8	142.90	115.90	39.70	60.53	51.60	19.04	16	111.0
49.212		MSF1-15/16				1055	6	161.90	127.00	43.70	64.31	55.60	22.24	16	130.0
50		SF50	•	•	•	1050	8	142.90	115.90	39.70	60.53	51.60	19.04	16	111.0
50		MSF50				1055	6	161.90	127.00	43.70	64.31	55.60	22.24	16	130.0
50.8		SF2R				1050	8	142.90	115.90	39.70	60.53	51.60	19.04	16	111.0
50.8		SF2			•	1055	9	161.90	127.00	43.70	64.31	55.60	22.24	16	130.0
50.8		MSF2				1055	6	161.90	127.00	43.70	64.31	55.60	22.24	16	130.0
53.975		SF2-1/8			•	1055	9	161.90	127.00	43.70	64.31	55.60	22.24	16	130.0
55		SF55			•	1055	9	161.90	127.00	43.70	64.31	55.60	22.24	16	130.0
55		MSF55				1060	7	174.50	138.10	47.60	73.69	65.10	25.44	16	143.0
55.562		SF2-3/16			•	1055	9	161.90	127.00	43.70	64.31	55.60	22.24	16	130.0
55.562		MSF2-3/16				1060	7	174.50	138.10	47.60	73.69	65.10	25.44	16	143.0
57.15		MSF2-1/4				1060	7	174.50	138.10	47.60	73.69	65.10	25.44	16	143.0
57.15		SF2-1/4			•	1060	10	174.50	138.10	47.60	73.69	65.10	25.44	16	143.0
60		SF60			•	1060	10	174.50	138.10	47.60	73.69	65.10	25.44	16	143.0
60		MSF60				1070	8	187.60	155.50	47.60	77.20	74.60	30.24	16	149.2
60.325		SF2-3/8			•	1060	10	174.50	138.10	47.60	73.69	65.10	25.44	16	143.0
61.912		SF2-7/16			•	1060	10	174.50	138.10	47.60	73.69	65.10	25.44	16	143.0
61.912		MSF2-7/16				1070	8	187.60	155.50	47.60	77.20	74.60	30.24	16	149.2
63.5		SF2-1/2			•	1065	10/65	174.50	149.50	47.60	73.69	65.10	25.44	16	143.0
63.5		MSF2-1/2				1070	8	187.60	155.50	47.60	77.20	74.60	30.24	16	149.2
65		SF65R				1065	10/65	174.50	149.50	47.60	73.69	65.10	25.44	16	143.0
65		SF65			•	1070	11	187.50	155.50	47.60	77.72	74.60	30.24	16	149.2
65		MSF65				1075	9	196.50	158.50	51.30	80.90	77.80	33.34	20	152.4
66.675		SF2-5/8			•	1070	11	187.50	155.50	47.60	77.72	74.60	30.24	16	149.2

Four Bolt Flange Units

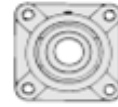

Shaft Diameter (mm)		RHP designation	Variations	Basic Insert	Casting group	Dimensions(mm)							
Metric Range	Imperial Range		A EC DEC			Casting Square L	Flange Diameter H	Flange Height A	Width Max A1	Inner Race Width B	Inner Race Centre s	Bolt Hole G	Bolt Centres J
68.262		SF2-11/16	•	1070	11	187.50	155.50	47.60	77.72	74.60	30.24	16	149.2
68.262		MSF2-11/16		1075	9	196.50	158.50	51.30	80.90	77.80	33.34	20	152.4
69.85		SF2-3/4	•	1075	12	196.50	158.50	51.30	80.90	77.80	33.34	20	152.4
69.85		MSF2-3/4		1075	9	196.50	158.50	51.30	80.90	77.80	33.34	20	152.4
70		SF70	•	1070	11	187.50	155.50	47.60	77.72	74.60	30.24	16	149.2
70		MSF70		1075	9	196.50	158.50	51.30	80.90	77.80	33.34	20	152.4
73.025		SF2-7/8	•	1075	12	196.50	158.50	51.30	80.90	77.80	33.34	20	152.4
74.612		SF2-15/16	•	1075	12	196.50	158.50	51.30	80.90	77.80	33.34	20	152.4
74.612		MSF2-15/16		1080	10	196.50	173.50	55.00	88.87	82.60	33.34	20	152.4
75		SF75	•	1075	12	196.50	158.50	51.30	80.90	77.80	33.34	20	152.4
75		MSF75		1080	10	196.50	173.50	55.00	88.87	82.60	33.34	20	152.4
76.2		MSF3		1080	10	196.50	173.50	55.00	88.87	82.60	33.34	20	152.4
80		MSF80		1085	11	213.50	184.00	54.30	89.64	85.70	34.15	20	171.5
80.962		MSF3-3/16		1085	11	213.50	184.00	54.30	89.64	85.70	34.15	20	171.5
82.55		MSF3-1/4		1085	11	213.50	184.00	54.30	89.64	85.70	34.15	20	171.5
85		MSF85		1090	12	213.50	196.50	61.70	100.76	96.00	39.74	20	171.5
87.312		MSF3-7/16		1090	12	213.50	196.50	61.70	100.76	96.00	39.74	20	171.5
88.9		MSF3-1/2		1090	12	213.50	196.50	61.70	100.76	96.00	39.74	20	171.5
90		MSF90		1090	12	213.50	196.50	61.70	100.76	96.00	39.74	20	171.5
95		MSF95		3095	13	267.50	235.50	83.50	126.95	117.48	49.31	24	211.1
100		MSF100		3095	13	267.50	235.50	83.50	126.95	117.48	49.31	24	211.1
100.012		MSF3-15/16		3095	13	267.50	235.50	83.50	126.95	117.48	49.31	24	211.1
101.6		MSF4		3095	13	267.50	235.50	83.50	126.95	117.48	49.31	24	211.1